

Yard drain System 400, DN 150, A, 580-710 mm

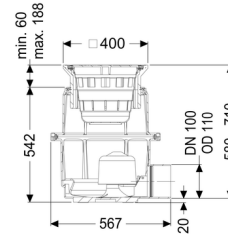

Article information

Item no.: 851151A
 GTIN: 4026092004371
 Price group: 10

Advantages

- Different load classes available
- Height-adjustable complete system
- Easy underground installation

Description

The polymer yard drain is used for point drainage and is resistant to aggressive wastewater. It is equipped with a sludge bucket and fuel resistant seals.

The polymer upper section enables continuous height and level adjustment.

Version:

System:	400
Odour trap:	included
Heating:	without
Waterproofing layer on the upper section:	Connection flange

General characteristics:

Nominal size (DN):	150
Outer diameter (OD):	160
Colour:	black
Standard:	EN 752

Dimensions:

Length:	563 mm
Width:	500 mm
Height:	580 mm
Cutout dimension, length:	585 mm
Cutout dimension, width:	535 mm
Min. insertion depth:	55 mm

Tank:

Installation depth:	580 - 710 mm
Groundwater resistant from lower edge of base section:	500 mm

Drain body:

Material of drain body:	Polymer
Socket version:	lateral
Vertical adjustment:	vertically adjustable upper section
Vertical adjustment:	55 - 180 mm
Adjustment range:	55 - 185 mm

Coverage features:

Type of cover:	Slotted cover
Cover material:	Polymer
Load class:	A 15 (EN 124)
Length:	400 mm
Width:	400 mm
Sludge bucket:	yes

Grating:

Rim length:	400 mm
Rim width:	400 mm
Shape of upper section:	square
Discharge rate (l/s) with 20 mm backwater:	4.5 l/s